

DESATM

HEARTH PRODUCTS

BRICK LINER KITS BL32S, BL36(H)(S) AND BL42(H)(S) INSTALLATION INSTRUCTIONS

**FOR USE WITH MODELS (V)P324, (V)P325, (V)M36 AND (V)M42
B-VENT FIREPLACE SERIES**

⚠ CAUTION: Turn off the gas supply, disconnect the electric circuit and allow the appliance to fully cool down before performing this installation. Glass and refractory panels may be heavy for some individuals. If this is the case, please request help from someone else.

ACCESSING FIREBOX

All Models

1. Remove both glass door panels (when equipped) by following the instructions shown in Figure 1.

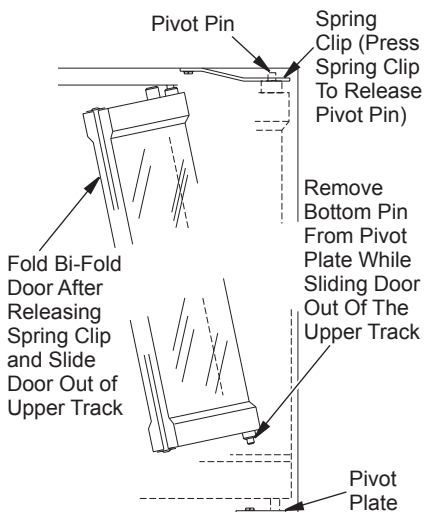

Figure 1 - Removing Glass Doors

2. Remove 2 screws retaining the screen assemblies and slide screen rods out of mounting holes located behind facial opening (see Figure 2).
3. Remove any hearth treatments (lava rock, pan material or embers) from around burner pan.
4. Remove front brick access panel by lifting and angling out of fireplace opening (see Figure 2).
5. On exposed installations, further access to control compartment may be gained by removing lower panel from facial opening. Remove panel by carefully pulling with your fingertips in louver openings (when equipped) or, on smooth panels by pushing out from inside fireplace until panel snaps free.

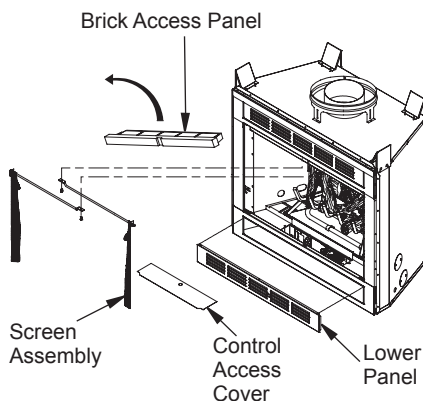

Figure 2 - Accessing Control Compartment

REMOVING LOGS AND BURNER PAN ASSEMBLIES

1. Remove logs and grate by lifting individually off burner pan assembly. Place them safely away from your work area.
2. Disconnect the 7/16" pilot line fitting and remove 2 thermopile leads connected to terminals marked TP/TH and TP on control valve (see Figure 3).
3. Disconnect ignitor lead wire connected at rear of piezo ignition device or at terminal marked IGN on module (electronic models) (see Figure 3).
4. Remove top screw on burner inlet shield. Remove burner inlet shield to expose burner and flex line fittings (see Figure 4).
5. Disconnect the 3/8" flare fitting on flex line using a 3/4" open end wrench on both the burner fitting and flare fitting (see Figure 4).

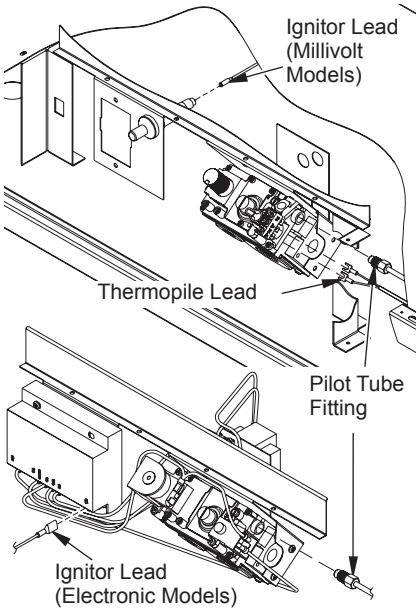

Figure 3 - Disconnecting Pilot Leads

6. Remove 4 Phillips head screws located on valve bracket and lift retaining flange off burner pan (see Figure 5).
7. Lift burner pan and draw pilot leads out through knockout pass on firebox (see Figure 5).

Note: Use a free hand to guide the leads around firebox from inside control compartment. Be careful not to bend, kink or damage leads.

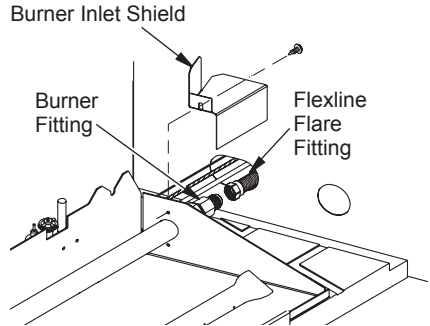

Figure 4 - Disconnecting Gas Flex Line Fitting

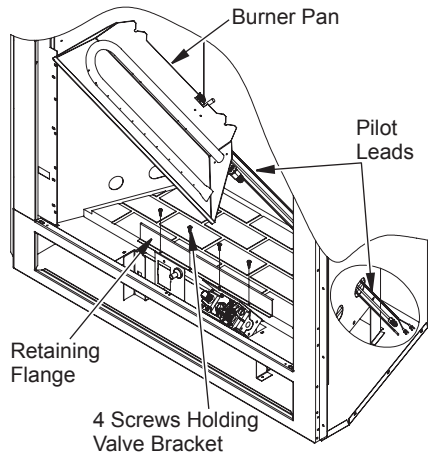

Figure 5 - Removing Burner Pan

REMOVING OLD REFRACTORY

1. If adding side brick refractory, you must remove and discard the 2 panel extenders located on either side of the smoke deflector. If this is a full brick replacement you also need to replace the bottom rear hearth brick in addition to the side panels (see Figure 6).
2. Remove 2 hex screws holding side brick retainers located near top of firebox on each side. Retain screws and brackets for later reinstallation (see Figure 7).
3. Remove side refractory panels (if applicable) by angling out one side panel first, followed by rear panel, and then remaining side panel. This will prevent rear panel from dropping and possibly causing injury (see Figure 7).

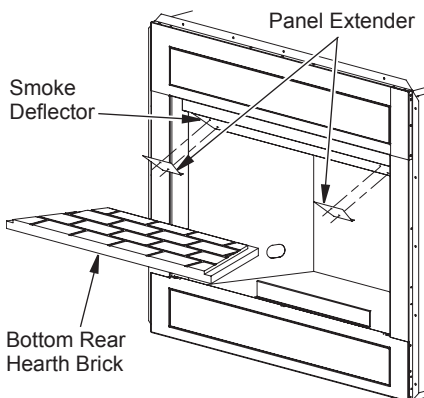
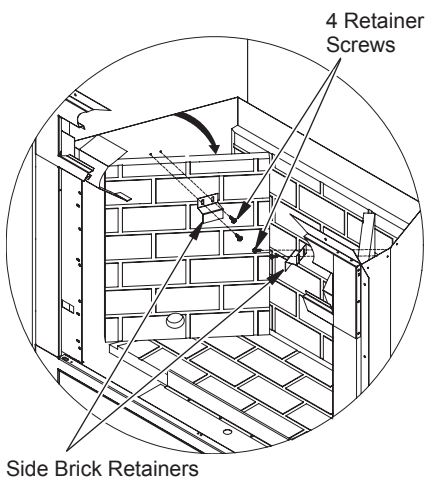

Figure 6 - Removing Panel Extenders



**Figure 7 - Removing Side Brick Panels
(Full Replacement)**

UNPACKING NEW REFRACTORY

1. Open both ends of carton, split lengthwise and spread carton out near your work area.
2. Arrange panels on top of packing and identify each piece in order of assembly (see Figure 8).
3. Check all items for any shipping damage. If damaged, contact your authorized dealer of this product. If the dealer can't supply original replacement part(s) call DESA Heating, LLC at 1-866-672-6040 for referral information. Be sure to have your kit model number and part number ready when you call.
6. Refer to parts list on page 4 for reference.

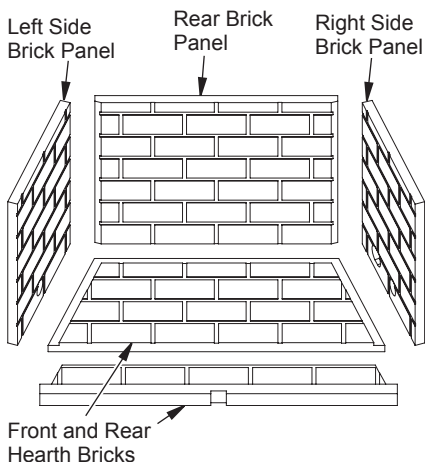

Figure 8 - Identifying Refractory

REPLACEMENT PART NUMBERS

KIT MODEL	Left Side Brick Panel	Right Side Brick Panel	Rear Brick Panel	Rear Hearth Brick	Front Hearth Brick
BL32S	108434-01	108432-01	108430-01	108426-01	108428-01
BL36S	106658-01	106659-01	106660-01	106661-01	106662-01
BL36	106658-02	106659-02	106660-02	106661-02	106662-02
BL36HS	108164-01	108165-01	108166-01	108167-01	108168-01
BL36H	108164-02	108165-02	108166-02	108167-02	108168-02
BL42S	107812-01	107814-01	107816-01	107818-01	107820-01
BL42	107812-02	107814-02	107816-02	107818-02	107820-02
BL42HS	108169-01	108170-01	108171-01	108172-01	108173-01
BL42H	108169-02	108170-02	108171-02	108172-02	108173-02

INSTALLING NEW REFRACTORY

1. Locate oval knockout pattern at bottom of right side brick panel.
2. Place end of a 1" diameter wood dowel or metal pipe inside knockout area and punch out entire 1" x 1.5" slotted area (see Figure 9).

NOTE: Clean bottom hearth pan of all debris before installing bottom hearth brick to prevent obstruction. To insure a proper fit of burner pan and valve bracket, there must be 3/8" of clearance from back edge of control access opening and leading edge of rear hearth brick.

3. Reinstall refractory panels in reverse order starting with bottom rear hearth brick, then rear panel and then both side panels.
4. Replace 2 side brick retainers using 4 hex screws removed previously.

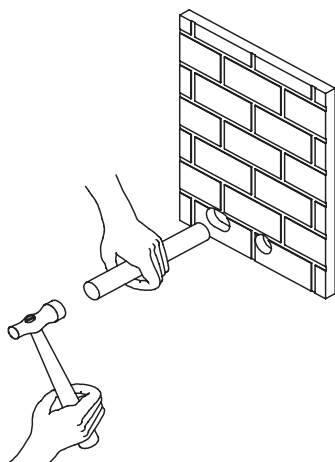

Figure 9 - Removing Knockout

REINSTALLING BURNER PAN ASSEMBLY

1. Pull gas flex line back through knockout hole in firebox.
2. Replace burner pan assembly, while feeding pilot leads back through knockout. With your free hand, carefully guide lines around outer firebox and into control compartment.
3. Place retaining flange on valve bracket back over leading edge of burner pan (see Figure 5, page 2).
4. Center pan to valve bracket and replace 4 pan head screws into valve bracket mounting locations (see Figure 5, page 2).
5. Hand thread pilot line fitting into control valve outlet and tighten using a 7/16" open end wrench (see Figure 10).

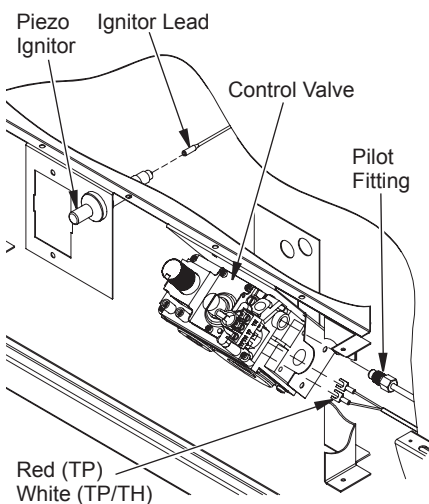

Figure 10 - Reconnecting Pilot Leads

6. Reconnect RED thermopile lead to terminal marked TP and WHITE thermopile lead to terminal marked TP/TH (see Figure 10, page 4).
7. Reconnect ignitor lead at back of piezo ignitor (millivolt models) or on control module terminal marked IGN (electronic models).
8. Thread 3/8" flex line fitting onto burner flare fitting. Tighten using a 3/4" open end or adjustable wrench. Make certain burner does not spin or misalign, burner tubes should have main gas port holes facing down into pan.
9. Reattach burner inlet shield with screw in top hole of burner bracket (see Figure 4, page 2).
10. Restore power and gas to unit. Follow the safety and lighting instructions found on the appliance information tag to check for gas leaks and proper pilot and main burner operation.
12. Reassemble logs onto grate, beginning with rear base log. See pages 6 and 7 for various model log placement.
13. Reinstall right fireplace screen assembly by inserting end rod into uppermost mounting hole in right screen pocket. Screw mounting lug into left most pilot hole behind and towards center of upper facing. Repeat for left assembly using mounting lug to the right of center. Screen rods should overlap at middle and readily conceal into side screen pockets.
14. Replace the control access cover and front brick access panel.
15. Reapply any lava rock treatments to hearth floor. **DO NOT PLACE LAVA ROCK IN THE BURNER PAN OR NEAR THE BURNER INLET SHIELD AREA.**
16. Replace the glass doors (if equipped) by following the instructions shown in Figure 1, page 1, in reverse order.

⚠ CAUTION: Be sure to inspect the components and wiring for damage before restoring power to the unit. Leak check all gas lines, especially at connection points, using noncorrosive leak detection fluid. NEVER CHECK FOR LEAKS WITH AN OPEN FLAME. Tighten all connects if necessary. Follow the lighting instructions found on the information tag and check for proper ignition and operation.

11. Replace vermiculite material back in burner pan and smooth to height and grade of pan edges. Reapply ember material and replace grate into pan notches. Leave a minimum of 1/2" air gap under grate bars. See Figure 11.

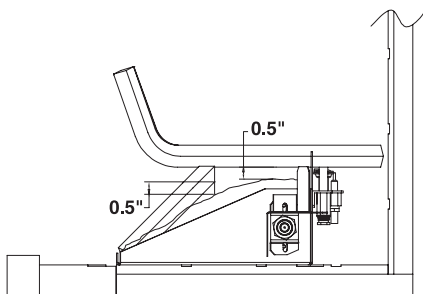
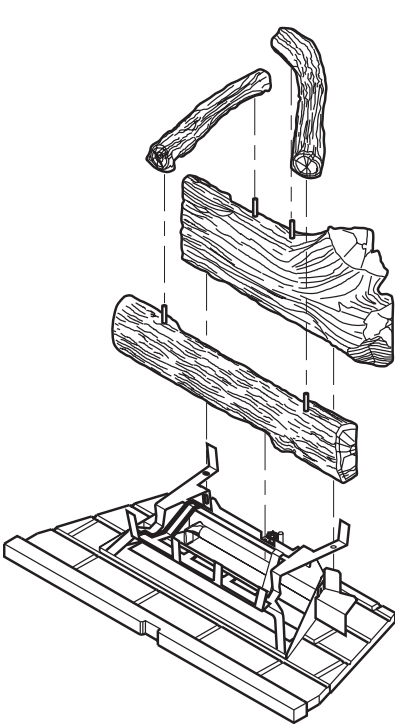
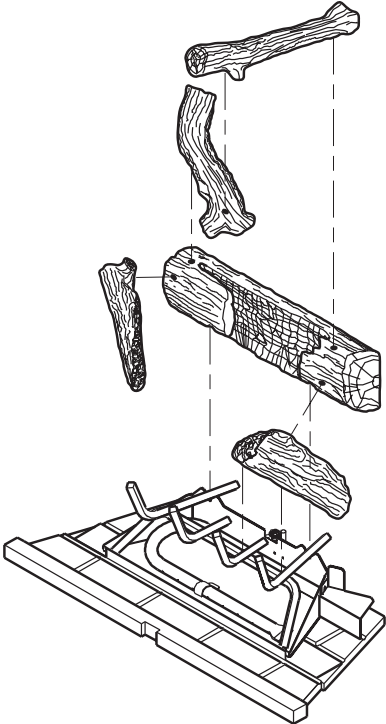

Figure 11 - Adding Pan Material

LOGS PLACEMENT



MODEL (V)P324



MODEL (V)P325

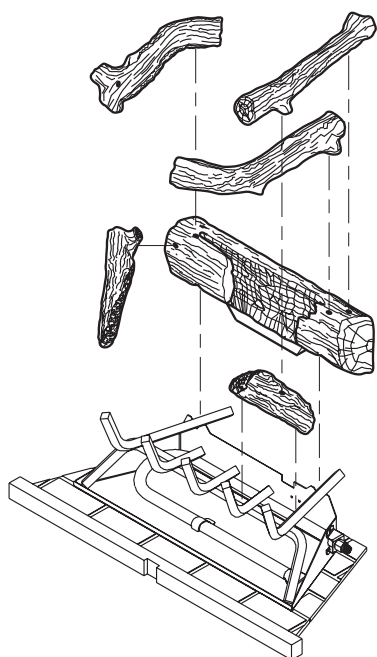

MODEL (V)M36

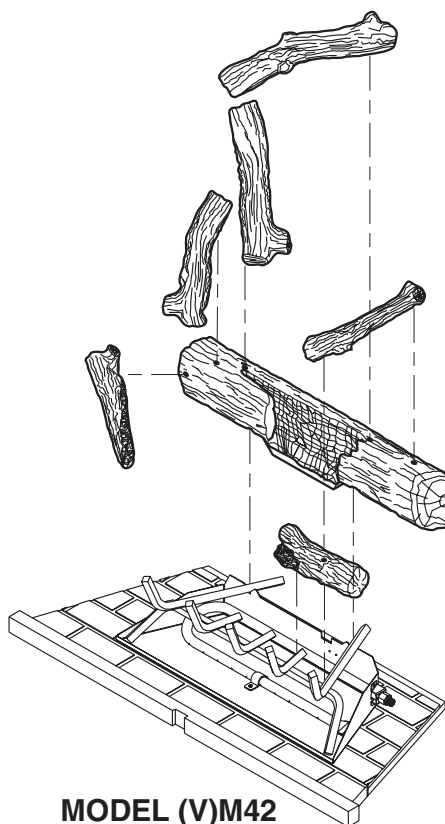

MODEL (V)M42



DESA Heating, LLC
2701 Industrial Drive
Bowling Green, KY 42101
www.desatech.com
1-866-672-6040



110181 01
NOT A UPC

110181-01
Rev. C
11/08